

# Exterior Sheathing



## Next generation insulation powered by graphite®.

Foam-Control MAX® is a next generation insulation product with a maximum R-value powered by graphite. Foam-Control MAX is a premium grade insulation manufactured to provide architects, specifiers, distributors, and contractors all the features and benefits inherent in a high quality insulation.

- High R-value that never changes and is stable over time
- High compressive strength of 15 or 25 psi
- Closed cell insulation with superior moisture resistance
- High drying potential to rapidly release absorbed moisture
- Meets code requirements for continuous insulation

## Powered by Graphite®.

Foam-Control MAX is comprised of many small pockets of air within a polymer matrix containing graphite. The graphite reflects radiant heat energy like a mirror, increasing the material's resistance to heat flow or R-value.

## Strength/R-value.

FOAM-CONTROL MAXX®	R-value <sup>1</sup>		Compressive Strength <sup>2</sup> , psi
	75°F	40°F	
150	5.0	5.2	15
250	5.0	5.3	25

<sup>1</sup> R-value units are °F-ft<sup>2</sup>-h/Btu and are based on 1-1/8" thickness.  
<sup>2</sup> Compressive strength @ 10% deformation.

Foam-Control MAX is available in a wide range of standard R-values and thicknesses to meet your needs.

### R-5, R-7.5, R-10, R-15, R-20

Product thicknesses for standard boards are provided in the Foam-Control MAX Thickness & R-value. Project requirements vary, so Foam-Control MAX can be ordered in any R-value thicknesses to meet your needs.

## Proven to meet, or exceed, building codes.

Foam-Control MAX is manufactured under an industry leading quality control program monitored by UL and further recognized in UL Evaluation Report UL ER11812-05. Foam-Control MAX meets ASTM C578, "Standard Specification for Rigid, Cellular Polystyrene Thermal Insulation".



## Stands up to the weather.

When tested in accordance with ASTM C1512, "Standard Test Method for Characterizing the Effect of Exposure to Environmental Cycling on Thermal Performance of Insulation Products" Foam-Control MAX maintains its R-value and strength after severe exposure to freeze-thaw cycles.

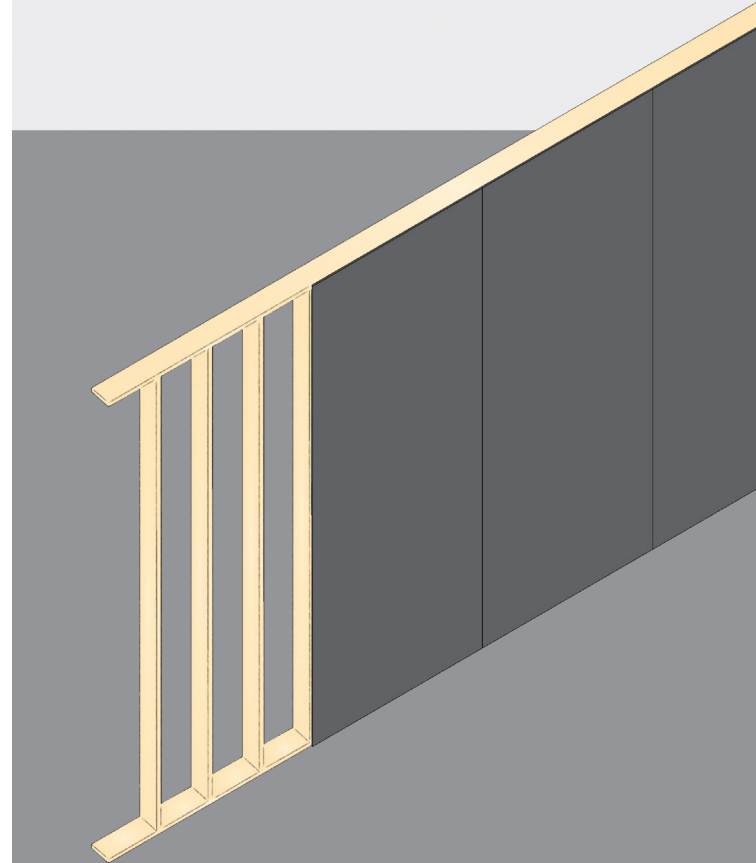

## FOAM FACTS: Foam-Control MAX outperforms XPS and Polyiso.

- Foam-Control MAX powered by graphite provides a stable long-term high R-value at a lower cost
- Foam-Control MAX uses a blowing agent with low global warming potential and low ozone depletion
- Foam-Control MAX meet strength requirements at a lower cost
- Foam-Control MAX, XPS, and Polyiso have resistance to moisture. Foam-Control MAX has a higher vapor permeance leading to superior drying potential
- Foam-Control MAX with **©Perform Guard**<sup>®</sup> treatment available to provide termite resistance

## Performance Value.

When you consider all performance characteristics and cost, Foam-Control MAX Powered by Graphite is your best choice for high R-value next generation insulation.

Foam-Control MAX has air in its closed cells and therefore has a stable R-value. Many other insulations use blowing agents that cause R-value loss and are harmful to the environment.

Foam-Control MAX has compressive strength to meet specific project requirements.

Foam-Control MAX is manufactured to resist moisture absorption in wetting conditions and release absorbed moisture quickly during drying periods, which means Foam-Control MAX maintains R-value.

## Termite Resistant - Perform Guard®.

One of the most destructive forces anywhere is termites. Foam-Control MAX can be manufactured with Perform Guard, a proven and safe additive, that effectively resists termites.

Foam-Control MAX with Perform Guard meets ICC ES AC239, "Acceptance Criteria for Termite-Resistant Foam Plastics".

## Recyclable.

After it's life as a building insulation, Foam-Control MAX is 100% recyclable. It can be ground into granules and reincorporated into new Foam-Control MAX products or it can be thermally processed into a resin that's used to manufacture other new products.

## Ready to take control? Start here.

If you're ready to have Foam-Control MAX contribute to your next project, just contact your nearest Foam-Control MAX manufacturer and Technical Sales Representative. They will be happy to give you design consultation, information about Foam-Control MAX products, pricing, and answers to all of your questions.

**ACH**  
FOAM TECHNOLOGIES

[WWW.ACHFOAM.COM](http://WWW.ACHFOAM.COM)



Foam-Control MAX products are manufactured by AFM Corporation licensees.

Copyright © 2019 AFM Corporation. All rights reserved. Printed in USA. Foam-Control MAX, Foam-Control MAX logo, Perform Guard, Powered by Graphite, and Next Generation Powered by Graphite are registered trademarks of AFM Corporation, Lakeville, MN.

UL logo is a registered trademark of UL LLC. USGBC logo is a registered trademark of U.S. Green Building Council.

FCM13-01/19



[www.foam-control.com](http://www.foam-control.com)

**NEXT GENERATION  
INSULATION POWERED  
BY GRAPHITE®**